

Best ways to get to SR FLASH (28c)
FLASH SEMINAR ROOM 28c (2nd floor)

- Laboratory 1 01-01e (B3)
- Directorate 01 (B3)
- Press and public relations 01 (B3)
- Company medical officer 01a (B3)
- Seminar room 3a-5 01b (B3)
- Library 01d (B3)
- Laboratory 2a, Theory 02a (B3)
- Computer centre, UCO 02b (B3)
- Radiation Protection D3 03 (D4)
- Storage building 03b (D4)
- Auditorium (DESY), entrance building 6 05 (B4)
- Administration building 06 (B4)
- Post, Guest services 06 (B4)
- Administration building 07 (B4)
- Guest house 8 07a (A4)
- Canteen, cafeteria, bank 09 (B4)
- Bistro 09a (B4)
- Workshop 10 (B4)
- Purchasing department 11 (C4)
- Central warehouse 11a (C4)
- Social counselling / works council 11a (C4)
- Gate lodge Notkestraße 12 (C5)
- (main gate)
- Gate lodge Luruper Chaussee 12a (E3)
- (side gate)
- Gas service 13a,b (C3)
- Vacuum laboratory 14 (C4)
- CSSB 15 (D3)
- MKK / Power station 16 (C3)
- Cooling plant DESY II 16d (C3)
- Heating plant 17 (C3)
- Site service yard 18,18a (D3)
- Carpenters' building 19 (D3)
- Synchrotron building 20 (C3)
- Power house DESY 20c (C3)
- LAOLA 22 (C3)
- Laboratory of the Universities of Hamburg and Lübeck 22a (C3)
- REGAE 23 (C3)
- LINAC II 24 (D3)
- PIA 24a (D3)
- DORIS experimental hall 25 (C2)
- Office and laboratory building EMBL 25a (C2)
- FS office and laboratory 1 25b (D2)
- Detector laboratory 25c (C2)
- FS office and laboratory 4 25d (C2)
- FS office and laboratory 5 & 2 25e,f (D2)
- Experimental hall I / LINAC III 26 (C3)
- FLA laboratory 26a (C3)
- DESY testbeam / experimental hall II 27 (C3)
- Testing area 27a (C2)
- Experimental hall III 28 (C2)
- Cryogenic hall 28a (C2)
- FLASH tunnel 28b (C2)
- FLASH experimental hall 28c (C1)
- FLASH experimental hall „Albert Einstein“ 28k (C1)
- FLASH experimental hall „Kai Siegbahn“ 28i (C1)
- FLASH2 undulator building 28g (C1)
- FLASH laser hut 28g (C1)
- Iron removal plant 29 (C2)
- Accelerator control room (BKR) / SINBAD 30 (C2)
- Supplying hall 30a (C2)
- Accelerator operation building 30b (C3)
- ARGUS detector 30e (C4)
- Accelerator components building 31a (C2)
- Guest house 2 32 (C5)
- Kindergarten 32c (C5)
- Guest house 3 33 (C5)
- Training area 34 (B3)

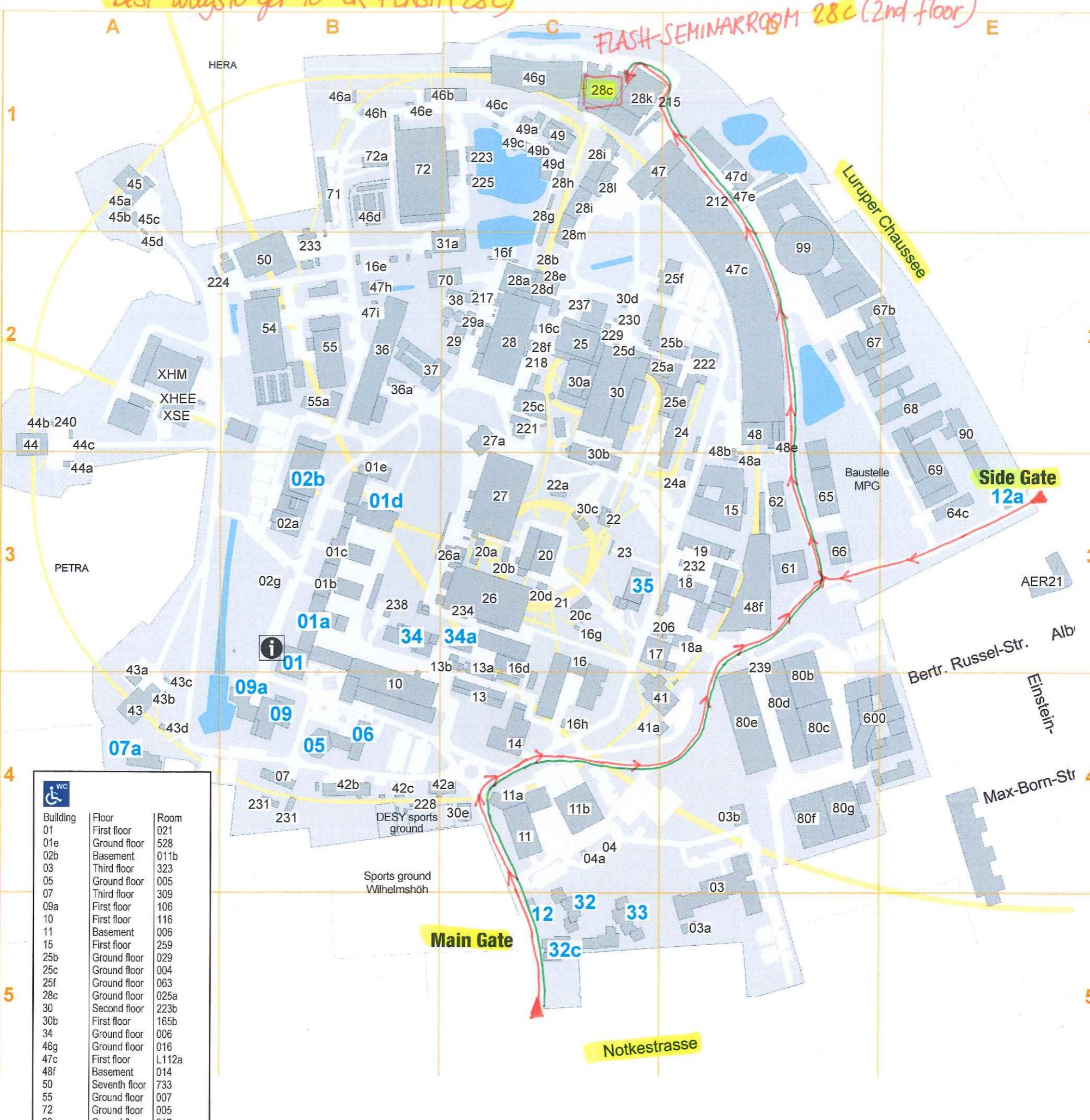

- (C3) 34a School lab physik.begreifen
 - (C3) 35 Safety group / SAVE communication engineering
 - (B2) 36 Preparation hall / experimental hall V
 - (B2) 37 Assembly hall
 - (C2) 38 Storage building
 - (C4) 41, 41a PETRA halls SO
 - (B4) 42, 42a-c PETRA halls S
 - (A4) 43, 43a-b PETRA halls SW
 - (A2) 44 PETRA halls W
 - (A1) 45, 45a-c PETRA halls NW
 - (B1/C1) 46a-c PETRA halls N
 - (C1) 46g PETRA III experimental hall „Paul P. Ewald“
 - (C1) 47 PETRA halls NO
 - (D1-2) 47c PETRA III experimental hall „Max von Laue“
 - (D1) 47d PETRA III cooling plant
 - (D2) 48, 48e PETRA halls O / EMBL
 - (D3) 48f PETRA III experimental hall „Ada Yonath“
 - (C1) 49, 49a Office and laboratory building
 - (B2) 50 HERA hall W
 - (B2) 54 Refrigeration technology hall (Cryogenic control room)
 - (B2) 55 Magnet measurement hall
 - (B2) 55a Proton vacuum building
 - 61-69 University Hamburg
 - (D3) 61 Auditorium (university)
 - (D3) 62 Institute of experimental physics
 - (D3) 65 Workshop
 - (D3) 66 HZG Helmholtzzentrum Geesthacht
 - (D3) 67 SALOME
 - (D-E2) 67-68 Institute of experimental physics
 - (E3) 69 Institute of laser physics
 - (C2) 70 Module test hall CMTB
 - (B1) 71 XTL mock up
 - (B1) 72 AMTF hall
 - (D4) 80b-g Storage buildings
 - (E2) 90 Centre for optical quantum technologies (ZOQ)
 - (D2) 99 CFEL
 - (E2) 90 Light & Schools (School lab)
 - (D2) 222 FS laser
 - (D/E4) 600 CHyN
 - (A2) 702 European XFEL entrance
 - (A2) 703 European XFEL modulator hall
 - (B2) 700 European XFEL injector entrance
- Off-site buildings:**
- 51 HERA hall N
 - 52 HERA hall E
 - 53 HERA hall S
 - (E3) AER21 Project management agency
 - (E4) NKS15 Finance departement (Notkestr. 15)

Building	Floor	Room
01	First floor	021
01e	Ground floor	528
02b	Basement	011b
03	Third floor	323
05	Ground floor	005
07	Third floor	309
09a	First floor	106
10	First floor	116
11	Basement	006
15	First floor	259
25b	Ground floor	029
25c	Ground floor	004
25f	Ground floor	063
28c	Ground floor	025a
30	Second floor	223b
30b	First floor	165b
34	Ground floor	006
46g	Ground floor	016
47c	First floor	L112a
48f	Basement	014
50	Seventh floor	733
55	Ground floor	007
72	Ground floor	005
99	Ground floor	017

Parking on the DESY premises is at your own risk. All city traffic regulations are valid and a speed limit of 30 km/h is allowed. Upon leaving the DESY premises random spot checks will be made at both gates. Please halt at the red traffic signal or the horn signal for inspection.